

AD Tevatron Overview

Site North

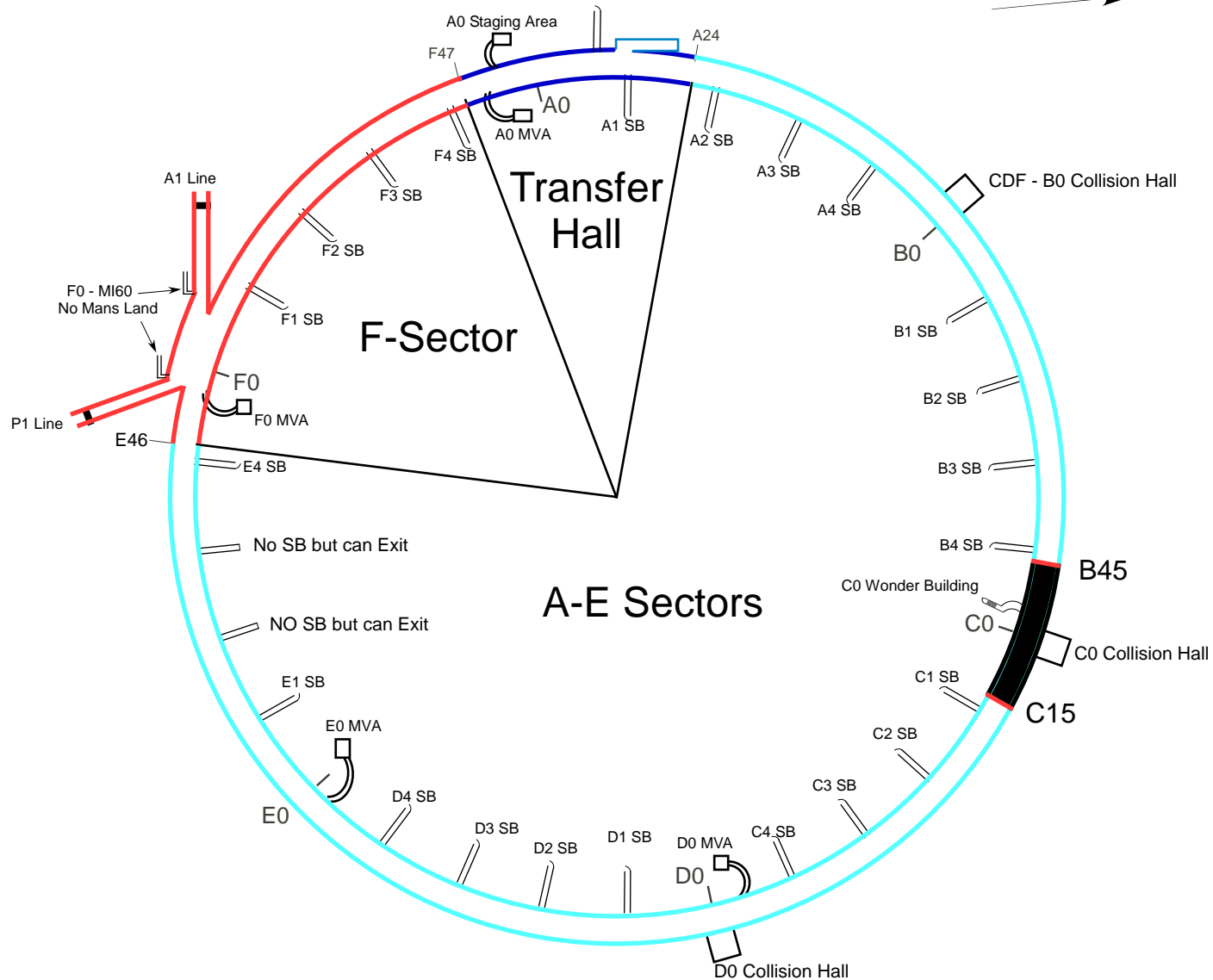

Note: The tunnel from B45 to C15 is a high radiation area and you will need RSO approval and a RHF key to access.
Transfer Hall access requires a Transfer Hall Key
F-Sector access requires a F-Sector key
A-E Sectors access requires an A-E Key

AD Enclosure - Transfer Hall

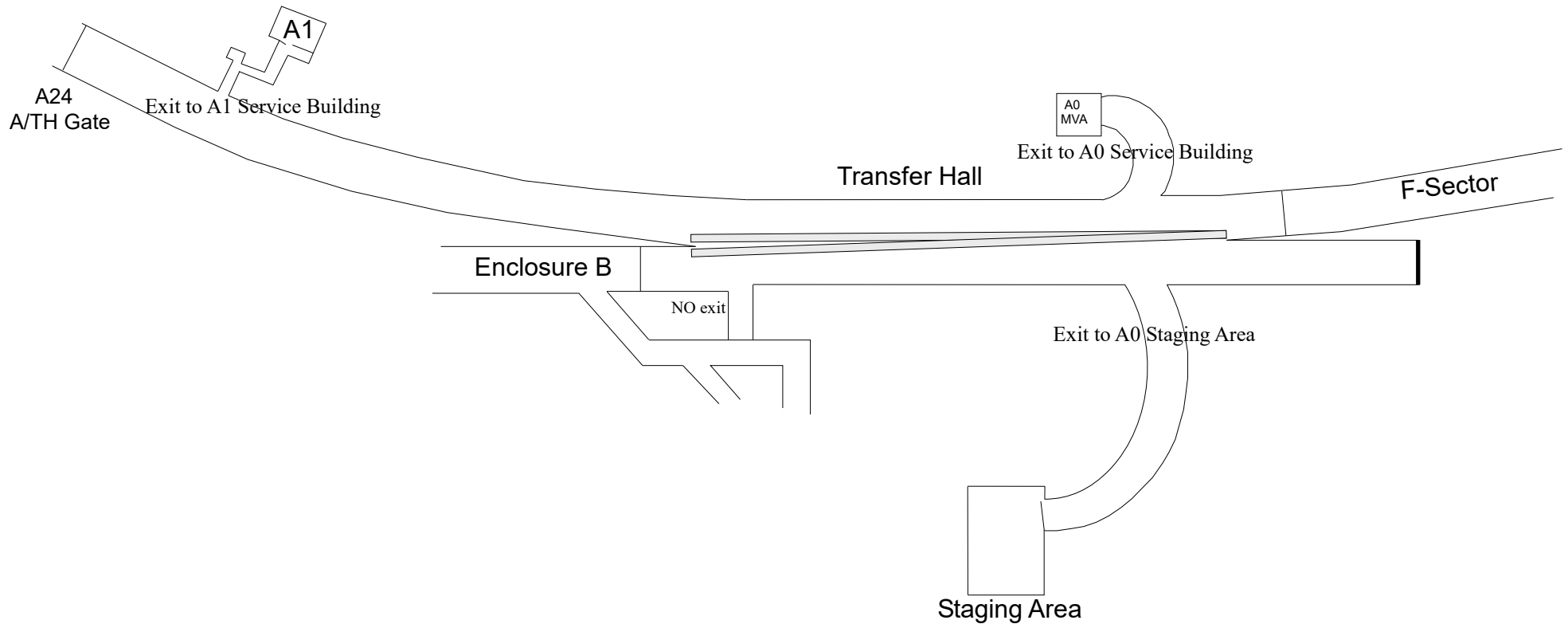

Note: To access the Transfer Hall you will need a Transfer Hall key.

AD Enclosure - B0 Collision Hall

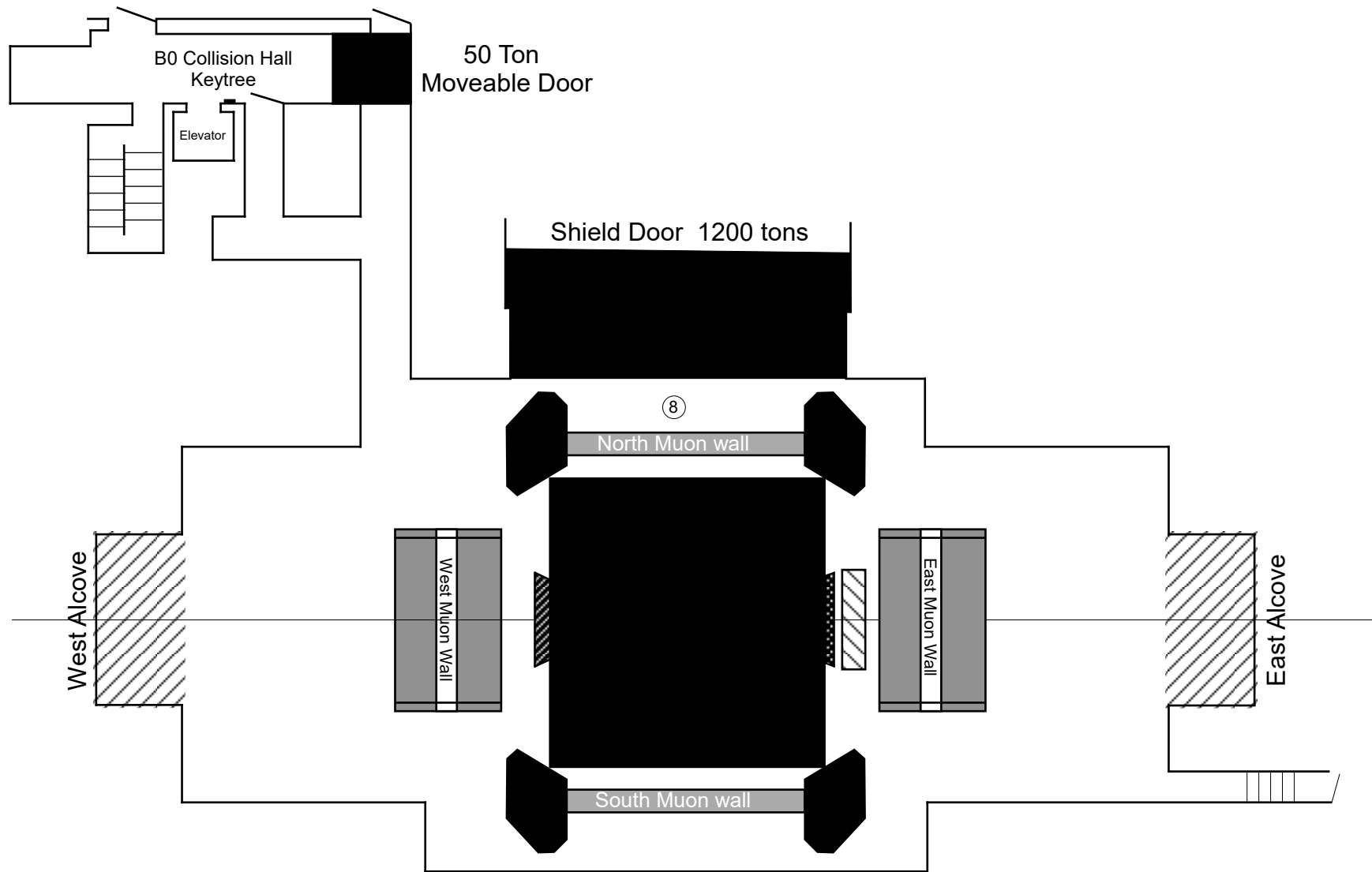

Note: To access the B0 collision Hall you will need a B0 collision hall key located at the keytree at the entrance to the enclosure.

AD Enclosure - A Sector

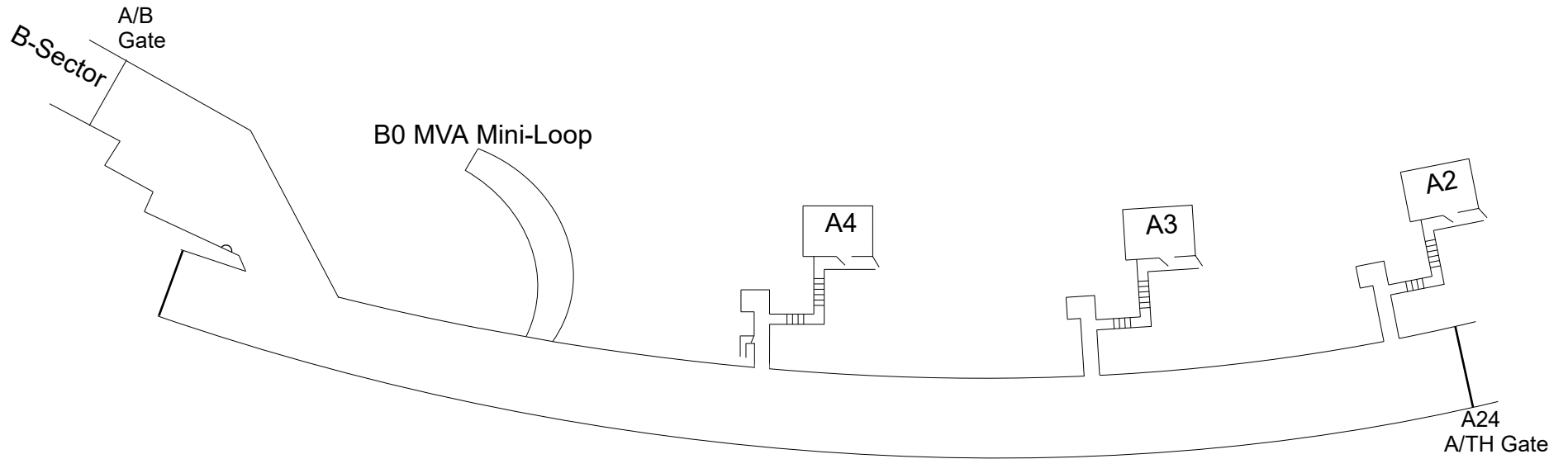

Note: To access A-Sector you will need a Tevatron A-E key.

AD Enclosure - B Sector

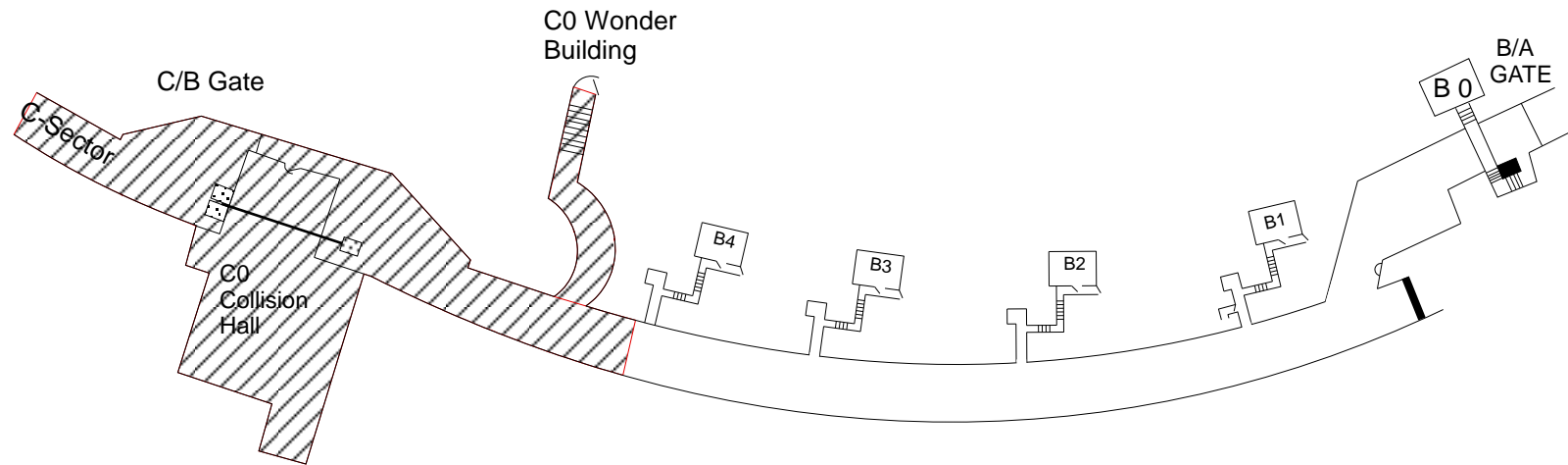

Note: Access requires a Tevatron A-E key.

B45 to C15 is a High Radiation area, you will need RSO approval and a RHF key to enter.

AD Enclosure - C0 Collision Hall

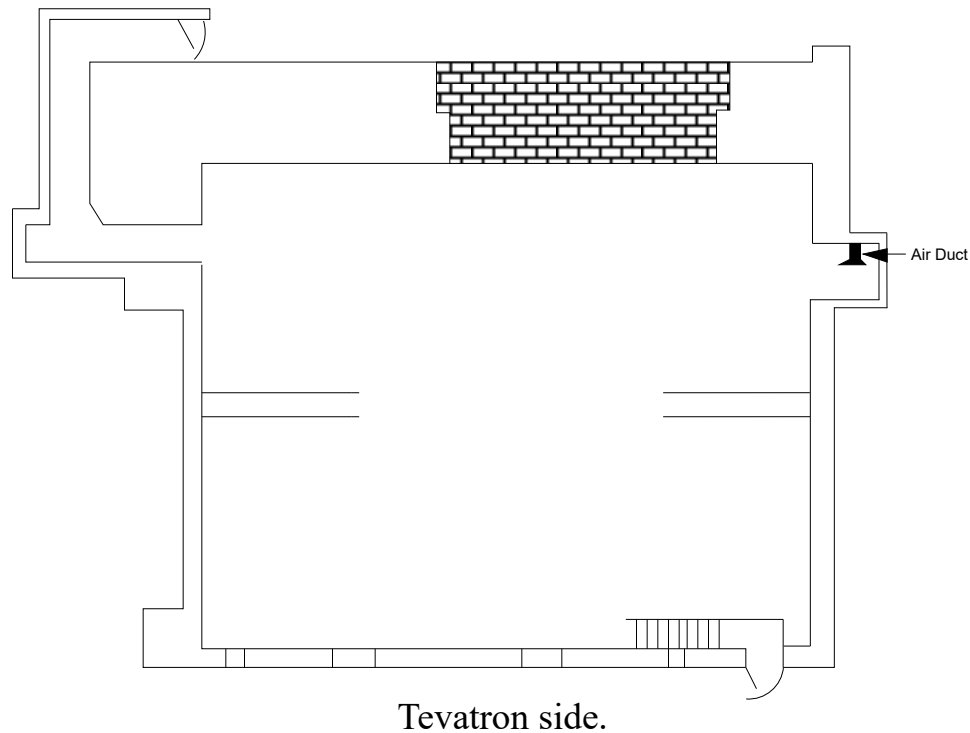

Note: To access the C0 collision hall from either the Tevatron or the service building you need permission from the RSO and RHF (C0 Assembly Building) key.

AD Enclosure - C Sector

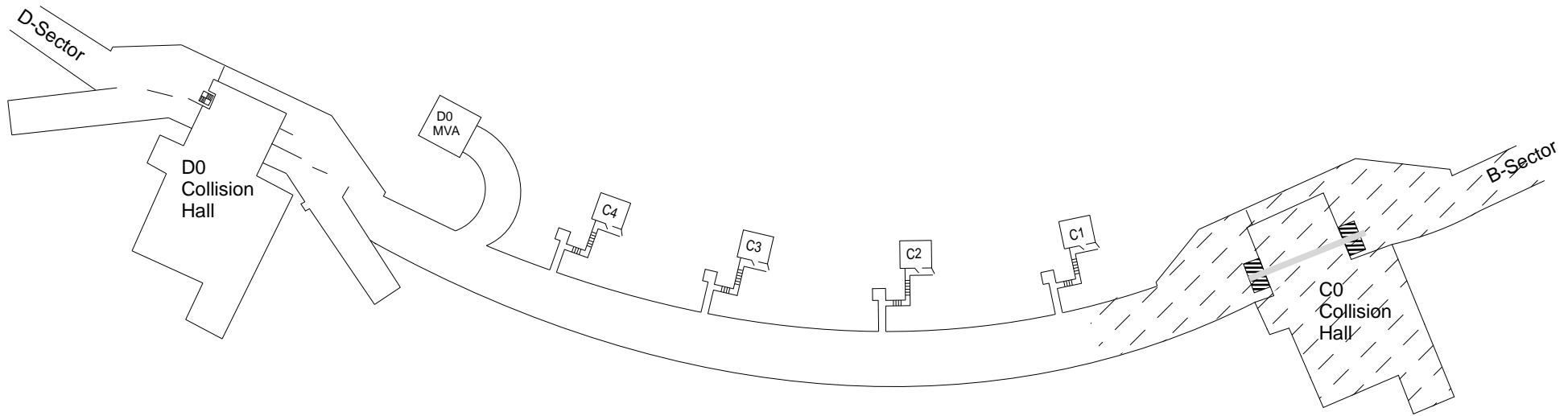

Note: Access requires a Tevatron A-E key;

From B45 to C15 is a High Radiation area, you will need RSO approval and a RHF key to enter.

AD Enclosure - D0 Collision Hall

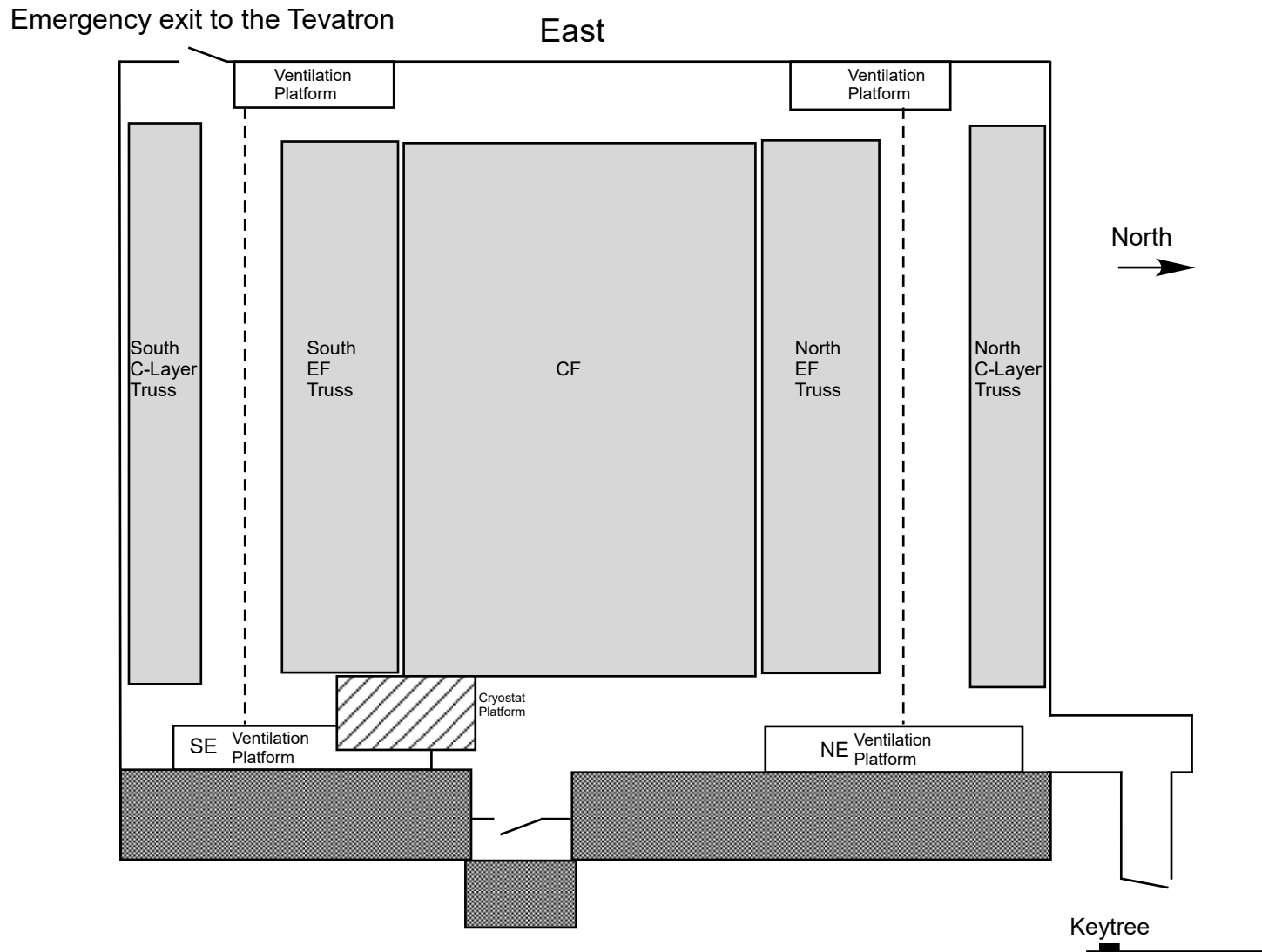

Note: To access the D0 Collision Hall you will need to have a D0 Collision Hall key located in Keytree outside the D0 Collision Hall.

AD Enclosure - D0 Collision Hall - Lower Level

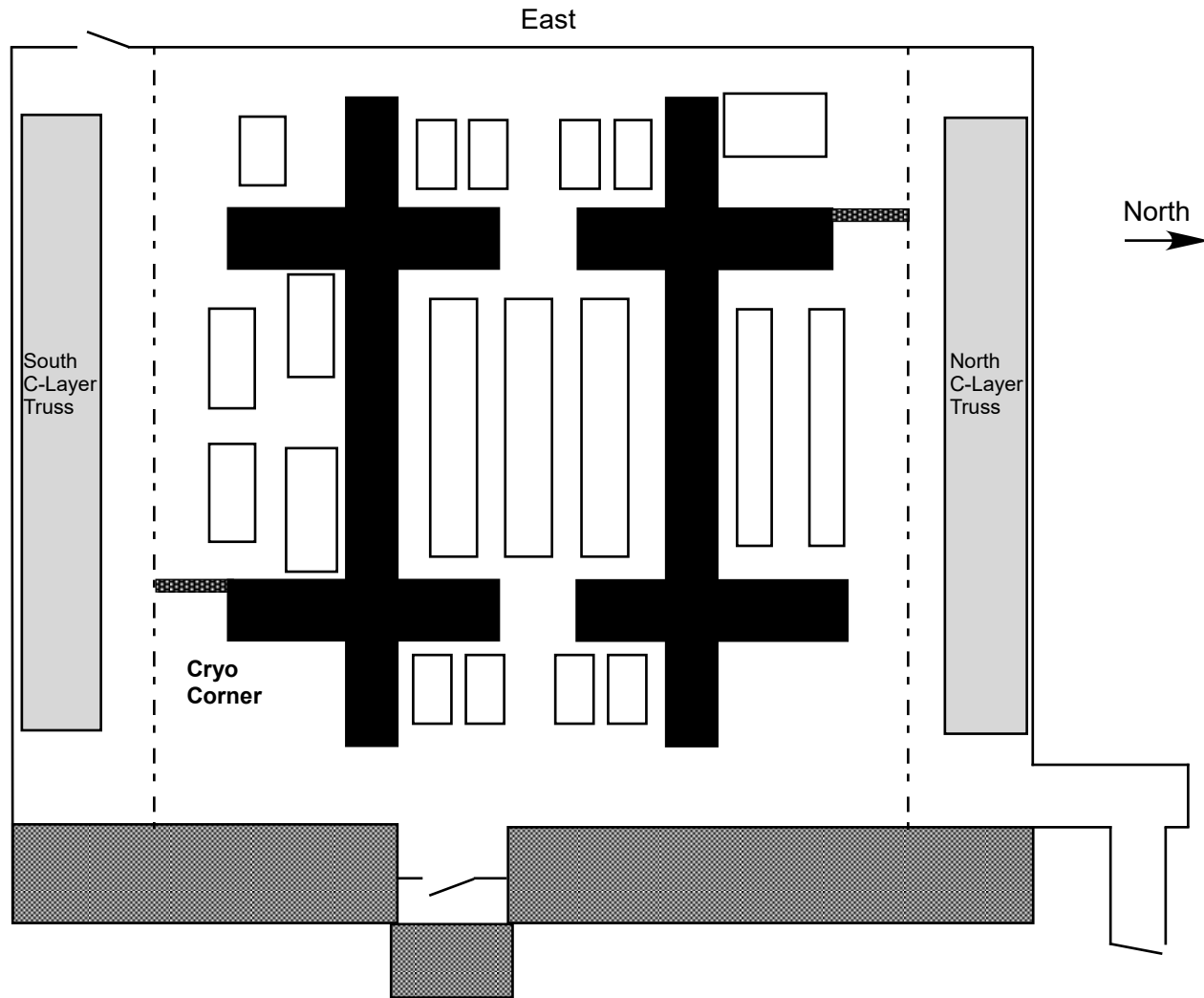

Note: To access the D0 Collision Hall you will need to have a D0 Collision Hall key located in Keytree outside the D0 Collision Hall.

AD Enclosure - D Sector

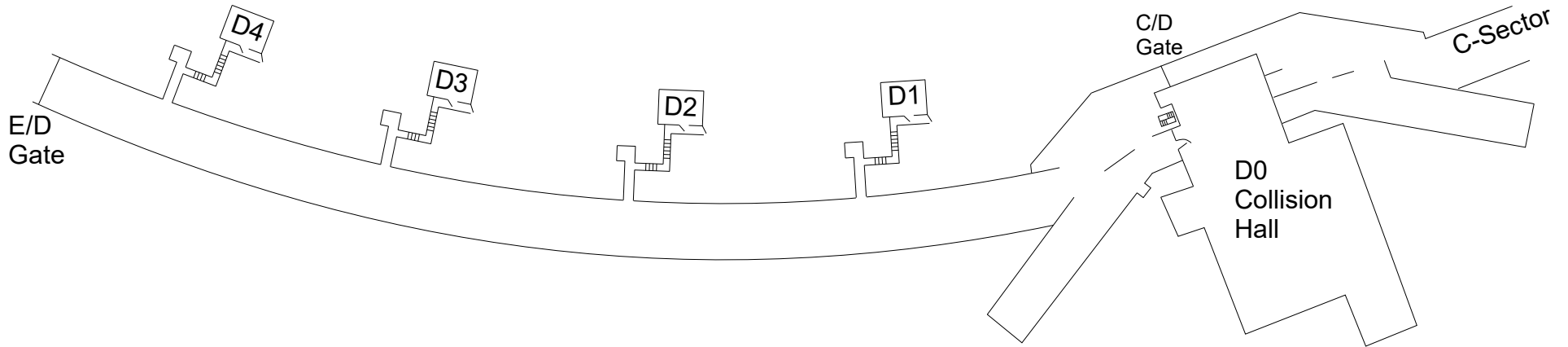

Note: To access the Tevatron D-Sector you will need a Tevatron A-E key.

AD Enclosure - E Sector

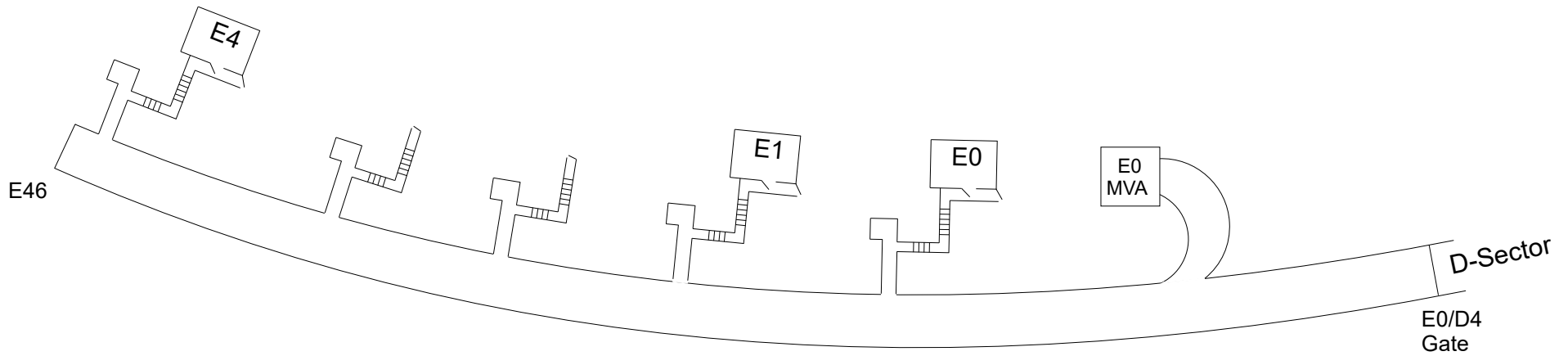

The E2 and E3 service building have been removed, but you still can exit through the stairwells, or through D-Sector or F-Sector.

Note: To access E-Sector you will need a Tevatron A-E key

AD Enclosure - F Sector

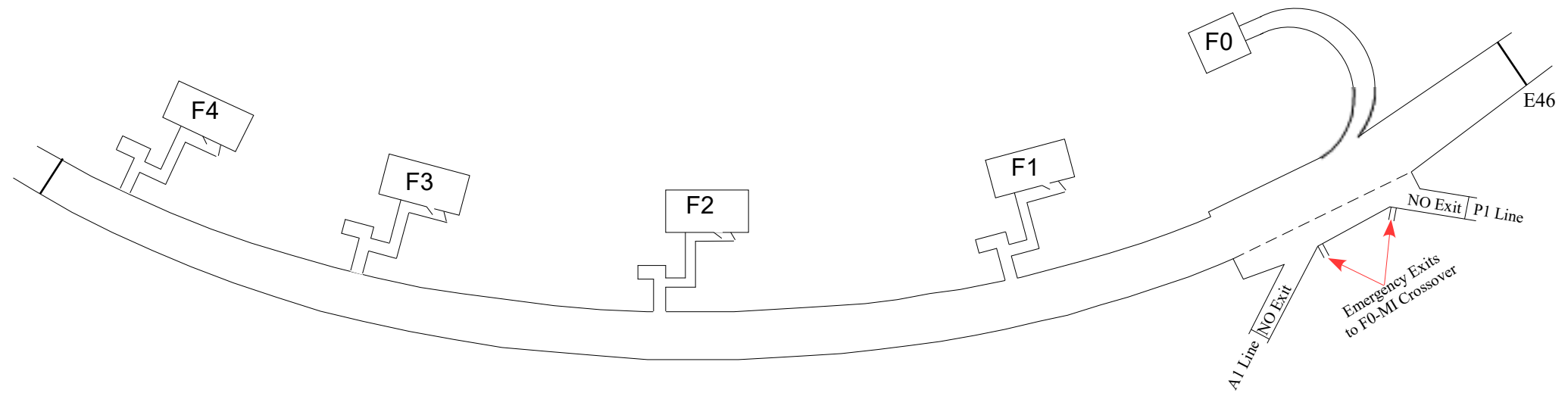

Note: To access the Tevatron F-Sector you will need a F-Sector key.

Tevatron F-Sector -- F0 Detail

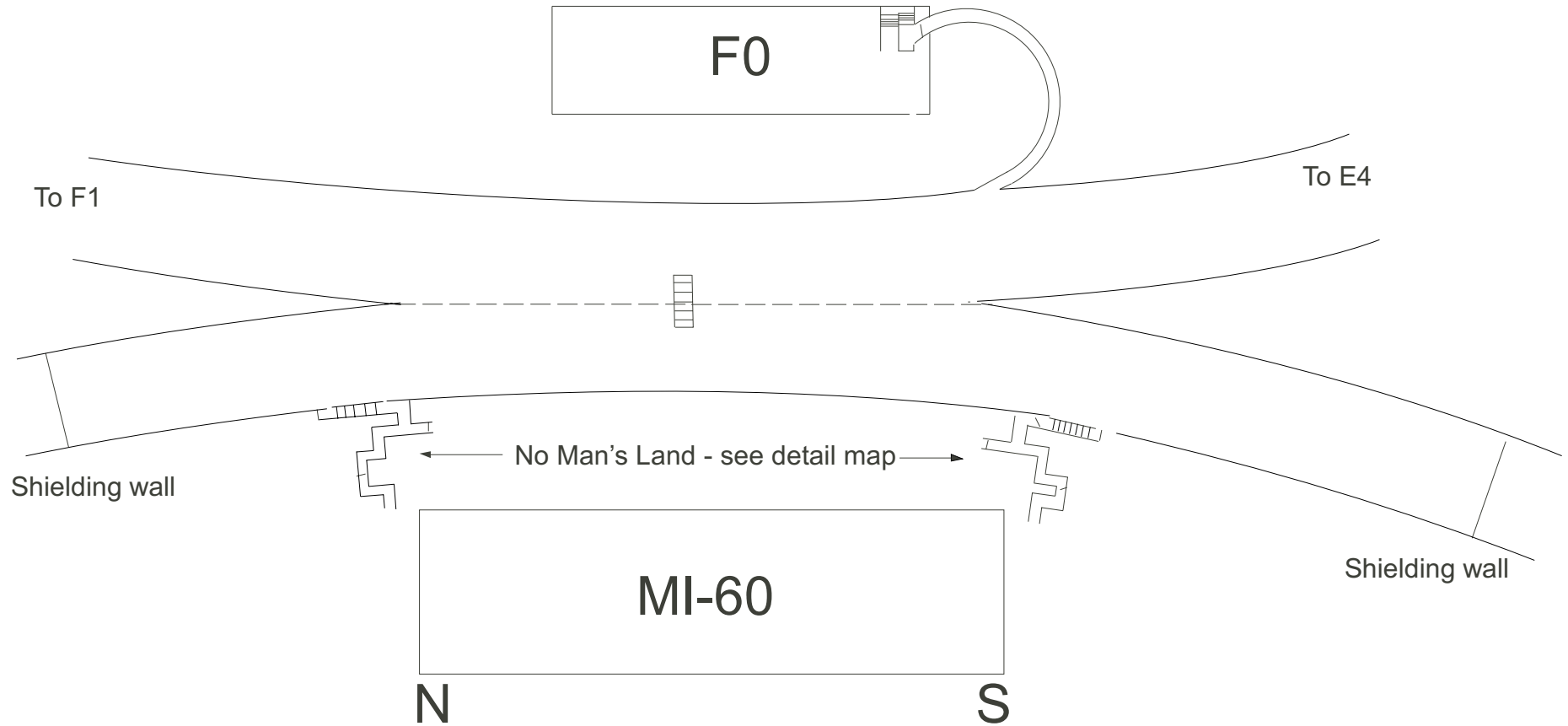

Notes:

Enclosure requires "Tev F-sector" key for entry

ODH 1

F0-MI60 No Man's Land



Notes:

No Man's Land is an emergency exit system only.
You cannot enter Tev F-sector or MI enclosures from inside.