

- TG4 ZRR - 46 -> 39
- 46 - Storage
- 45 - Storage
- 44 - Switchyard Crate #40
- Repeater
- 43 - Safety System Interface #46 - Booster
- 42 - CATV Monitor
- 41 - Storage
- 40 - Storage
- 39 - Storage

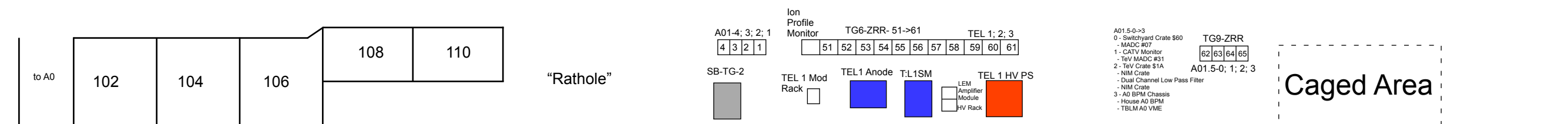

- A01.1 -> 4
 - 1 - TeV Crate #0A
 - Repeater
 - MADC #25
 - 2 - Safety System TeV Gate Valve Control Unit
 - Frig A FE
 - 8 Port Active Arctnet Hub
 - 3 - Beam Valve Abort System
 - CIA Crate (TeV A0 186)
 - IP 1-4
 - IP 5-8
 - IP 9-13
 - IP 14-16
 - IP 10
 - TEL2 Vacuum Interlock Chassis
 - IG01, IG02
 - IG02, IG04
 - 4 - CIA Crate (TeV A0-2 186)
 - TATIP8M, TATIPB & C
 - TEL 1 Vacuum Interlock
 - TATIG8A, TATIG8B
 - (2) Sublimation Pump Control Unit
- 50 - Ion Profile Monitor
 - 51 - Main Ring IP MAN and BS PS
 - 52 - Storage
 - 53 - CATV Monitor
 - Switchyard MADC #9
 - Beamline Beam Loss Monitor
 - AME - ADCL1
 - AME - ADCL2
 - AME - ADTGT1
 - TF49H; TF49V
 - TF48UH, TF48DH, TF48UV, TF48DV, TA01UH, TA01UH, TA01DH, TA01UV, TA01DV
 - 54 - Repeater Crate
 - Switchyard Crate #50
 - Switchyard Crate #51
 - Control's stuff
 - 55 - MI Crate #A0
 - MADC #20
- 56 - Safety System #82 - X-Fer
 - Safety System #83 - X-Fer Hall
 - ODH Chassis - T.A0DOXY & T.A0LOXY
 - ODH Chassis - A0 MVA - T.A0FOXY & T.A0COXY
 - ODH Chassis - Staging Area - T.SAFOXY & T.SACOXY
 - ODH Chassis - Enclosure B - T.EBFOXY & T.EBCOXY
 - ODH Chassis - T-Hall North - T.THFOXY & T.THCOXY
 - Ultrastab #50R Transducer Head 2000
 - 57 - IRM
 - Bertan PS (2 banks, not used)
 - Bertan Model 210-20R HV PS
 - (2) Agilent 33220A Wave Form Generator
 - LeCroy Wave Runner
 - TEL 1 BPM
 - NIM Crate
 - BPM Bias Supply PS
 - 58 - TeV Electron Lens DC Control PS Chassis
 - Cathode PS Collector PS 480 Vac Interlock Chassis
 - #3 Cathode Filament PS
 - Scope (telescope.fnai.gov)
- 59 - IRM
 - TransREC 148 (131.225, 124.176)
 - TeV Electron Lens PS, Digital Interface to IRM
 - Quench Proton
 - Short Corrector 1 A & B
 - Short Corrector 2 A & B
 - Short Corrector 3 A & B
 - Main Solenoid 1 A & B
 - Long Corrector 1 A & B
 - Long Corrector 2 A & B
 - Voltage Monitor
 - Main Solenoid
 - Long Corrector 1
 - Long Corrector 2
 - Short Corrector 1
 - Short Corrector 2
 - Short Corrector 3
 - Short Corrector 4
 - TL1SM
 - TeV Electron Lens DC Control PS Chassis
- 60 - TL1C5
 - Long Corrector 1 EMS PS
 - TL1C6
 - Long Corrector 2 EMS PS
 - 61 - Auto Polarity Reversal Chassis
 - TL1C1
 - Short Corrector 1 EMS PS
 - TL1C2
 - Short Corrector 2 EMS PS
 - TL1C3
 - Short Corrector 3 EMS PS
 - TL1C4
 - Short Corrector 4 EMS PS

A0 Kicker Room

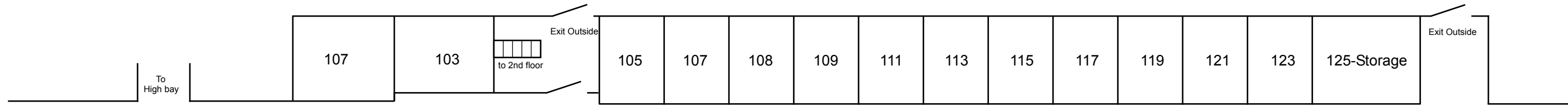
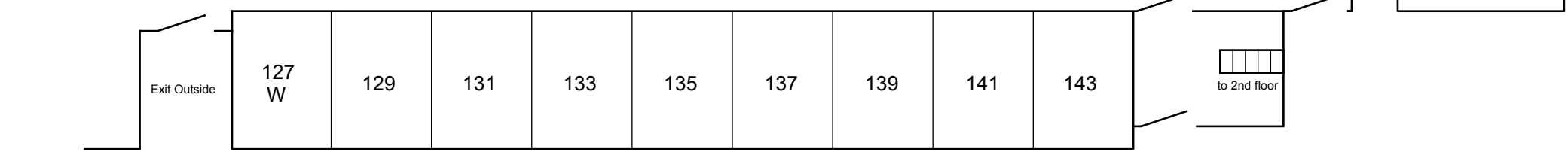

- 74 - B-XQ3, B-NQ3, B-XQ4, B-NQ4
 - B-XQ1, B-NQ1, B-XQ2, B-NQ2
 - B-TG7BS
 - 73 - B-H4, B-V4, B-NS4, B-XS4
 - B-H3, B-V3, B-NS3, B-XS3
 - Hot-Link Rack Monitor
 - VME
 - Switchyard Crate #70
 - B-H2, B-V2, B-NS2, B-XS2
 - B-H1, B-V1, B-NS1, B-XS1
 - 72 - Storage
 - 71 - MI MADC #26
 - MI Crate #A1
 - MI Crate #A2
 - Pulsar System
 - (2) Digital Continuous Power System
 - 70 - Storage
- 88 - CATV Monitor
 - NIM Crate
 - Switchyard Crate #10
 - 87 - LM Stuff
 - 86 - LM Stuff
 - 91 - Storage
 - 90 - Switchyard Crate #80
 - MADC #06
 - 89 - Switchyard Crate #81
- 92 - Repeater Crate
 - S.MLAM Current Transfer chassis
 - T-Hall/Enclosure B Magnet Interlock Chassis
 - Enclosure C Magnet Interlock Chassis
 - 93 - Storage
 - 94 - Storage
 - 95 - Storage
 - 96 - Storage
 - 97 - Storage
 - 98 - Storage
 - 99 - Storage
 - 100 - Storage
 - 101 - Storage
 - 102 - Storage
 - 103 - Storage
 - 104 - Storage
 - 105 - Storage
 - 106 - Storage
 - 107 - Storage
 - 108 - Storage
 - 109 - Storage
 - 110 - Storage
 - 111 - Storage
 - 112 - Storage
 - 113 - Storage
 - 114 - Storage
 - 115 - Storage
 - 116 - Storage
 - 117 - Storage
 - 118 - Storage
 - 119 - Storage
 - 120 - Storage
 - 121 - Storage
 - 122 - Storage
 - 123 - Storage
 - 124 - Storage
 - 125 - Storage
 - 126 - Storage
 - 127 - Storage
 - 128 - Storage
 - 129 - Storage
 - 130 - Storage
 - 131 - Storage
 - 132 - Storage
 - 133 - Storage
 - 134 - Storage
 - 135 - Storage
 - 136 - Storage
 - 137 - Storage
 - 138 - Storage
 - 139 - Storage
 - 140 - Storage
 - 141 - Storage
 - 142 - Storage
 - 143 - Storage
- 5 - Storage
 - 4 - Storage
 - 3 - Auto Reversing Chassis
 - TL2C1 Short Corrector
 - TL2C1 EMS PS
 - TL2C2 Short Corrector
 - TL2C2 EMS PS
 - TL2C3 Short Corrector
 - TL2C3 EMS PS
 - TL2C4 Short Corrector
 - TL2C4 EMS PS
 - 2 - DC PS 2
 - TL2C5 Long Corrector
 - TL2C5 EMS PS
 - TL2C6 Long Corrector
 - TL2C6 EMS PS
 - 1 - IRM
 - TEL 2 PS to IRM
 - TEL 2 PS Digital Interface to IRM
 - QPM A - TL2SM, TL2C5, TL2C6
 - QPM B
 - DC PS 1
 - TEL 2
- 91 - BPM Stuff
 - TL2C5 Long Corrector
 - TL2C5 EMS PS
 - TL2C6 Long Corrector
 - TL2C6 EMS PS
 - 92 - SWIC Controller
 - BPM Stuff
 - 93 - 8 Port Active Arctnet Hub
 - (2) SWIC Controller
 - AC Motor Controller System
 - 94 - Safety System Interface - #88 - X-Fer Hall
 - Safety System Interface - #108 - Enclosure CDE
 - Safety System Interface - #109 - Enclosure B
 - SWIC Controller
 - Profile Monitor Wire Chamber Chassis
 - Glassman HV PS
 - S.MSIPV ION Pump
 - S.MSPD ION Pump
 - 95 - Switchyard Crate #90
 - Repeater Crate
 - MADC #101
 - SY Motion Control Station
 - VME
 - S.MSEP1U; S.MSEP1D; S.MSEP2U; S.MSEP2D;
 - Step Pak Motor Power Transformer
- 96 - CIA Crate (G9 186 Card)
 - Cold Cathode Gauge Chassis
 - 97 - Switchyard Crate #91
 - SY-BPM-91
 - SY-BPM-92
 - 98 - CATV Monitor
 - CATV Modulator
 - VME
 - 99 - MADC #11
 - Switchyard Crate #92
 - S.CPS16 - Bulk Supply
 - 100 - Switchyard Crate #93
 - (2) 4 Correctors
 - (1) 3 Correctors
 - 101 - Switchyard MADC #16
 - 1/2 High Crate - S.MSEP1V
 - 102 - Scope
 - NIM Crate
 - 103 - IRM
 - Pos+ EMS PS
 - Scope
 - Bertan PS

A0 Kicker Room

Transfer Gallery, to print use "Tabloid" size, 11x17